

Vista: B-B

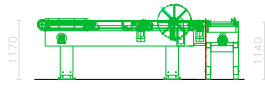

Vista: C-C

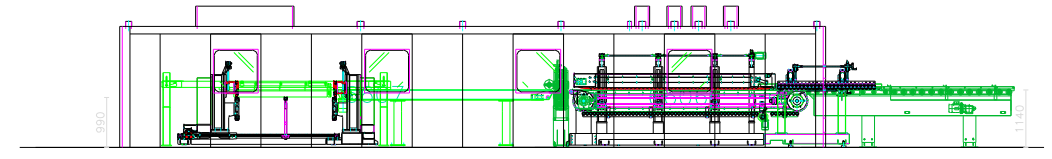

Vista: D-D

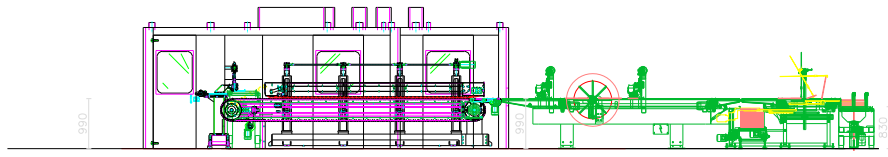

Vista: E-E

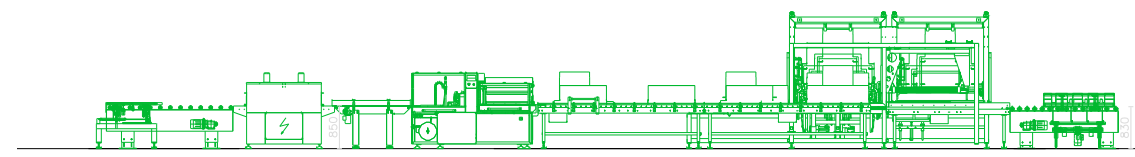

Vista: F-F

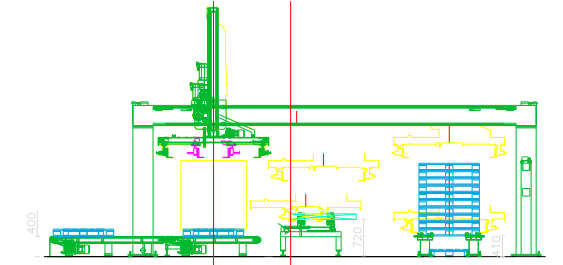

Vista: G-G

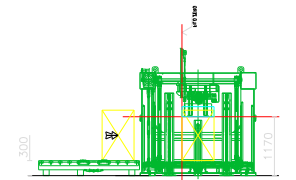
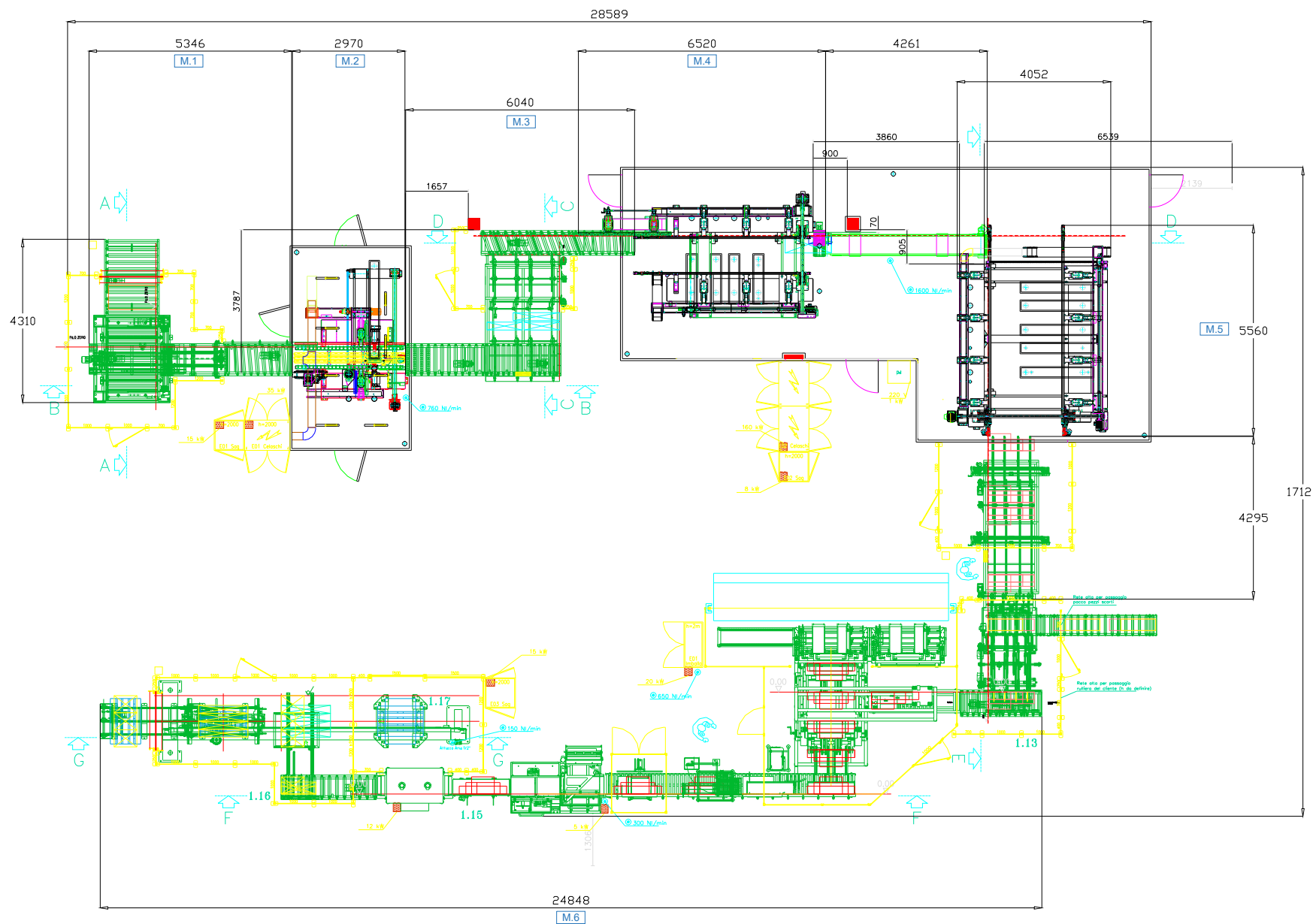

Vista: A-A

- | | | | |
|-----|--------------------|--------|------------------------|
| M.1 | LOADING AUTOMATION | 006476 | SAG CAR/S 2008 P |
| M.2 | SPLITTER MACHINE | 006477 | CELASCHI MODUL T2-2400 |
| M.3 | TRANSFER 90° | 006478 | SAG SCOSCIUTO |
| M.4 | DOUBLE END TENONER | 006479 | CELASCHI MODUL T4-4230 |
| M.5 | DOUBLE END TENONER | 006480 | CELASCHI MODUL T5-4815 |
| M.6 | PACKNG LINE | 006481 | ARTEMA PACK AP-WA-980 |

Disegnatore: FerWood spa

Titolo: 006555_LI

Descrizione: Double End Tenoning and packing Line
SAG - CELASCHI - ARTEMA PACK

FerWood®
BRILLIANT SOLUTIONS FOR WOOD

FerWood spa - Via Langhe 4/A 1204 ~ Pollenzo (CN) Italy
Tel: +39 0172 474073 - fax: +39 0172 471442

email: info@ferwoodgroup.com

Data: Sistema:

Foglio: A3

Tutti i diritti sono riservati da Copyright vietata la riproduzione All rights reserved by Copyright is forbidden to reproduce