

T1	Ø [mm]	Q [M³/h]
C	160	2200
	160	2200
	160	2200
F	160	2200
	160	2200
	160	2200
V	100	850
	100	850
	120	1220
X	100	850
	120	1220
LAS	80	540

T2	Ø [mm]	Q [M³/h]
C	120	1220
F	120	1220
G	160	2200
	160	2200
M	160	2200
	160	2200
N	160	2200
S	160	2200
V	100	850
	100	850
	120	1220
X	100	850
	120	1220

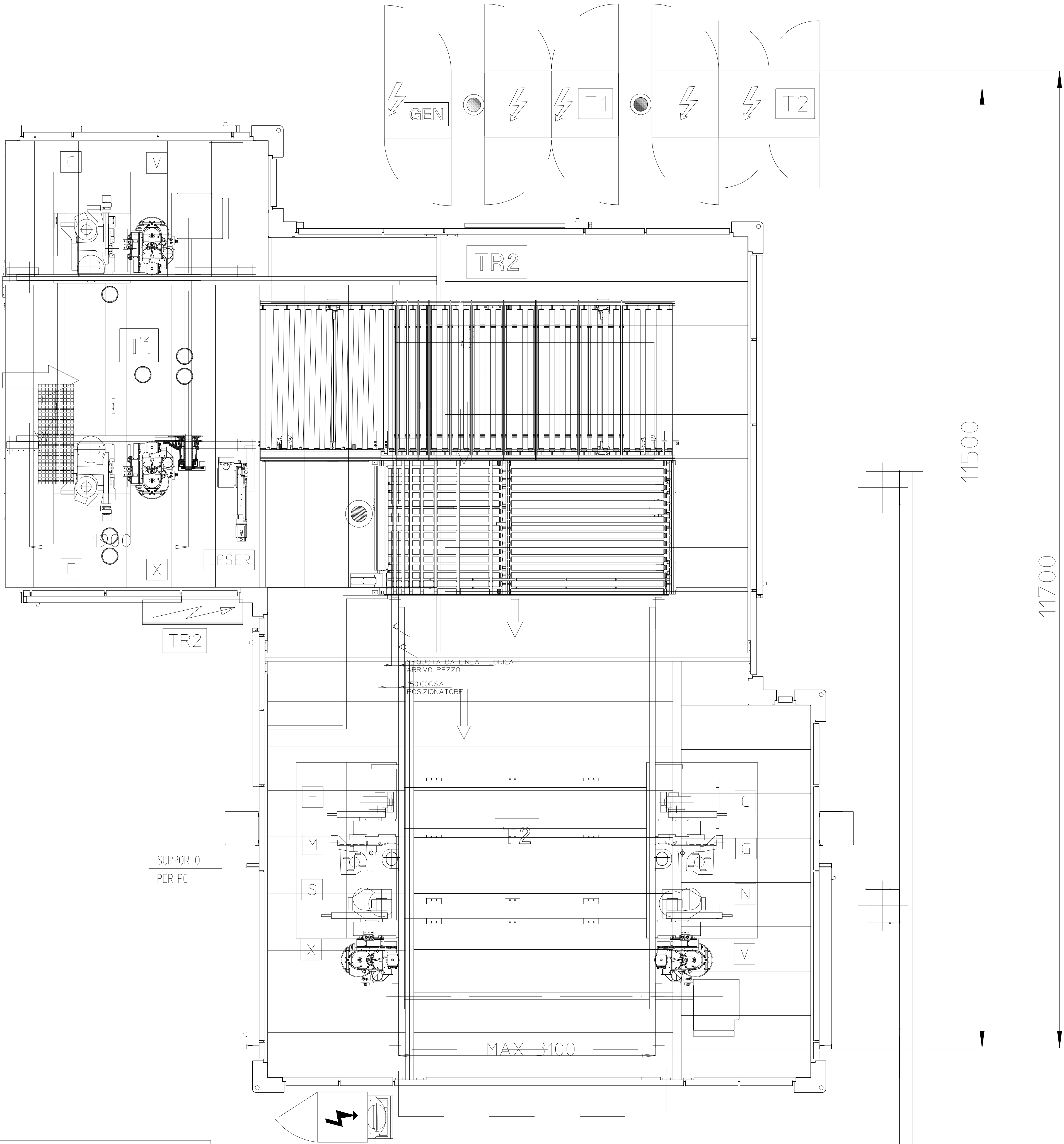

ASPIRAZIONE ARIA
VEL. CONSIGLIATA : 30 M/SEC

T1	P [bar]	Ø [r]	Q tot [NI/min]
●	6	1/2	400

Un [V]	400
f [Hz]	3+N
In [A]	175
Icu [kA]	10

T2	P [bar]	Ø [mm]	Q tot [NI/min]
●	6	1/2	500

Un [V]	400
f [Hz]	3+N
In [A]	228
Icu [kA]	10

TR1	P [bar]	Ø [r]	Q tot [NI/min]
●	6	1/2	200

Un [V]	400
f [Hz]	3+N
In [A]	36
Icu [kA]	10

TR2	P [bar]	Ø [r]	Q tot [NI/min]
●	6	3/4	100

Un [V]	400
f [Hz]	3+N
In [A]	13
Icu [kA]	10

GEN	Un [V]	f [Hz]	In [A]
●	400	3+N	452

FerWood
BRILLIANT SOLUTIONS FOR WOOD

PROJECT:	
CODE:	003450
TYPE:	Squaring Line
BRAND:	SCM + MAHROS
DESIGNER:	
DATE:	04.04.2019
FILE:	

SCARICO
ANTE